

New Unit Information



EB 30/1
EB 30/1 Professional
1.545-...

General Information

- Battery-operated, single-motor electric brush.
- Working width 300 mm
- Cardan joint
- Ergonomic handle
- Ram protector

Connection data

- Voltage, rechargeable battery: 7.2V, 1.5Ah

Standard accessories

- Brush roller (black)
- Sweeping container (volume 1.0 l)
- Telescopic tube with ergonomic handle
- EB 30/1
 - One rechargeable battery (operating time 30-45 minutes).
 - Standard battery charger, charging time approx 12 hours.
- EB 30/1 Professional
 - Two rechargeable batteries / 1x interchangeable (operating time 30-45 minutes each).
 - Quick battery charger, charging time approx 50 minutes.

Special accessories

- Brush roller (red)
- Replacement rechargeable battery (operating time 30-45 minutes)
- Battery charger (55 min) for 1 rechargeable battery (standard for professional versions)
- Battery charger (55 min) for 4 rechargeable batteries

View from the front



- 1 Holder for telescopic tube
- 2 Recess for latch nose, telescopic tube
- 3 Pushbutton unit switch (S1)
- 4 Release button, sweeping container
- 5 Retaining screw, Cardan joint
- 6 Spherical arresting device of the Cardan joint
- 7 Ram protector
- 8 Unlock button, rechargeable battery
- 9 Rechargeable battery (G1)

Rear view



- 1 Cardan joint
- 2 Unlock button, brush roller
- 3 Rechargeable battery (G1)
- 4 Wheel (2x)
- 5 Recess for removing the rechargeable battery
- 6 Sweeping container
- 7 Release button, sweeping container
- 8 Pushbutton, unit switch (S1)

View from underneath

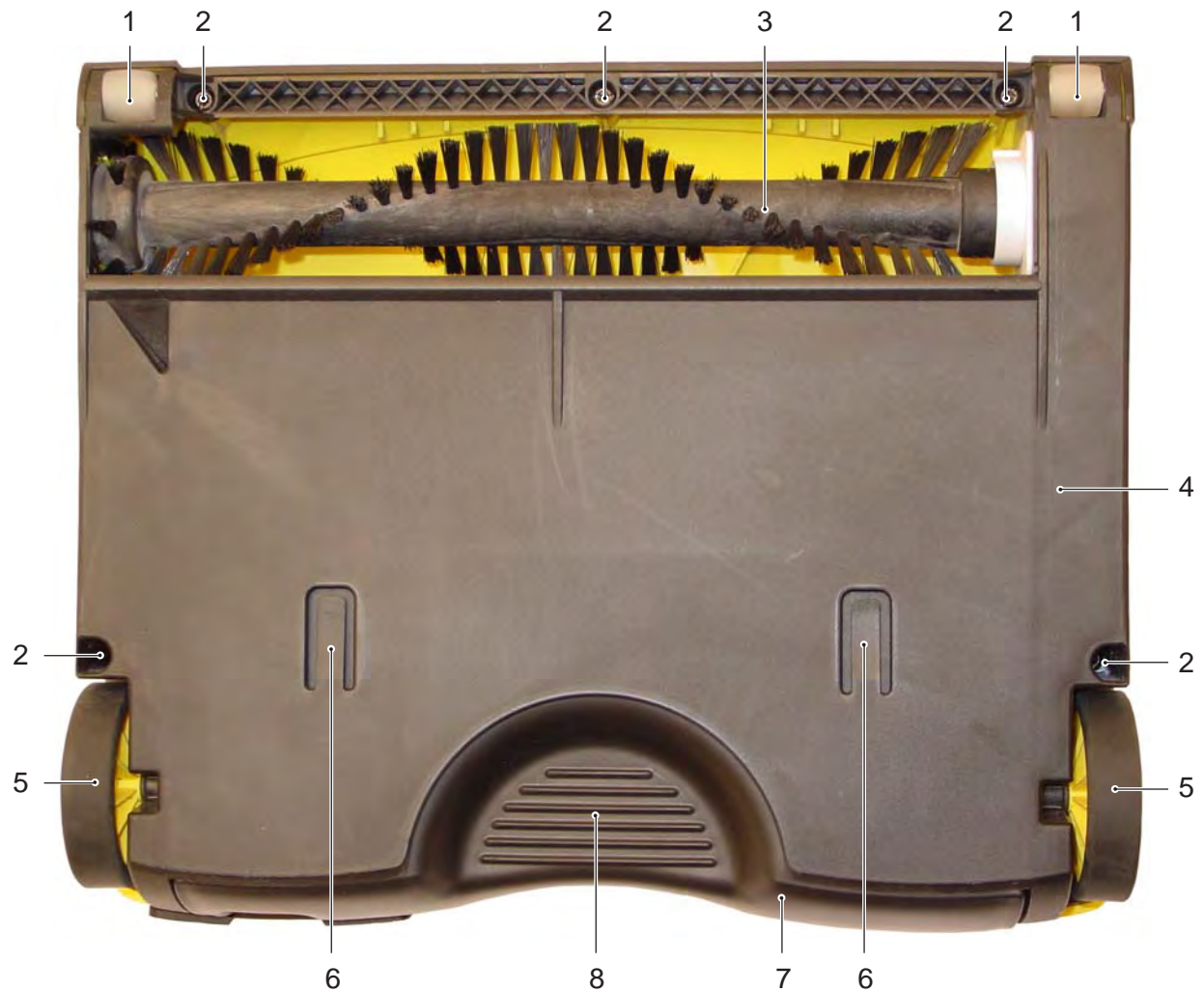

- 1 Roller wheel (2x)
- 2 Retaining screws (5x), lower housing
- 3 Brush roller
- 4 Lower housing
- 5 Wheel (2x)
- 6 Shackle (2x), for securing the sweeping container
- 7 Sweeping container
- 8 Handle, sweeping container

Telescopic tube with ergonomic handle

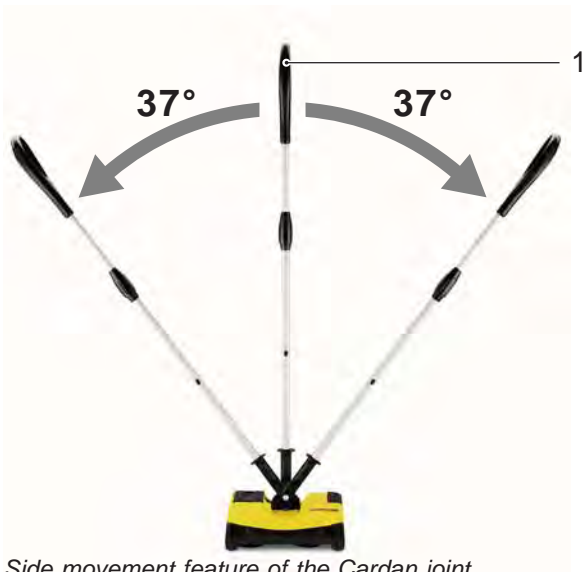

Side movement feature of the Cardan joint

Using the unit

Thanks to the Cardan joint, the unit is very easy to manoeuvre. The telescopic tube (1) can be tilted approximately 37° to the left and right. In the direction of travel, 90° tilt adjustment is possible to reach difficult to access places.

Dismantling the telescopic tube

For space-saving storage, the telescopic tube (1) can be dismantled by pressing in the latch nose (3) and the two latch noses (see p 7, Items 2 and 4).

Variable height adjustment of the telescopic tube

The height of the telescopic tube can be adjusted as follows.

- Hold onto upper part of the telescopic tube (4).
- To release the rotating handle for height adjustment (5), turn in an anti-clockwise direction (A).
- Adjust the length of the telescopic tube (4) by pulling it out (D) or pushing it in (C).
- After adjusting to the required length, turn the rotating handle for height adjustment (5) in a clockwise direction (B) until it is securely held.



Connection, handle with telescopic tube

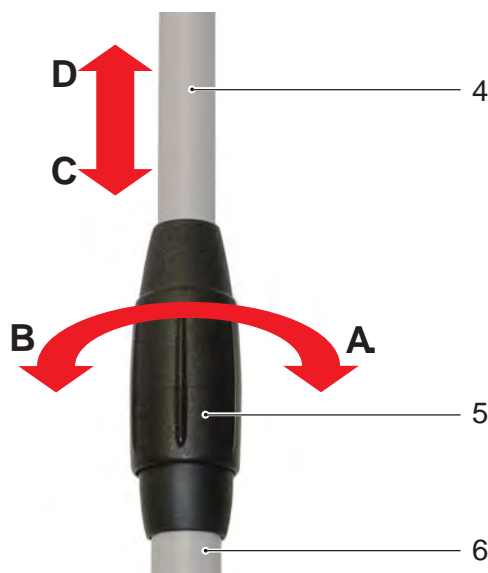

Height adjustment, telescopic tube

- 1 Telescopic tube, complete
- 2 Ergonomic handle
- 3 Latch nose, for fixing the handle to the upper part of the telescopic suction tube
- 4 Telescopic tube, upper part
- 5 Rotating handle for height adjustment
- 6 Telescopic tube, middle section

Telescopic tube with ergonomic handle

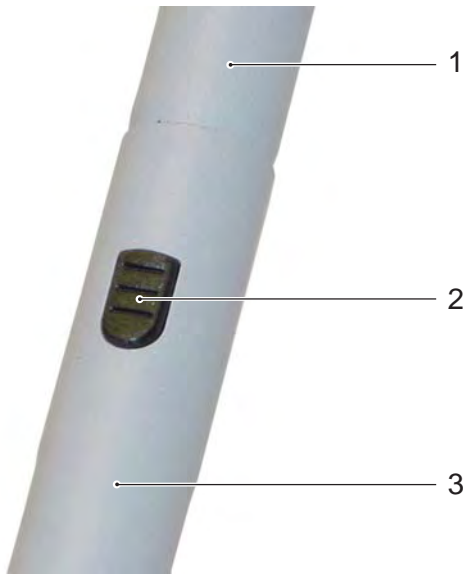

Connection, middle section of telescopic tube to lower tube

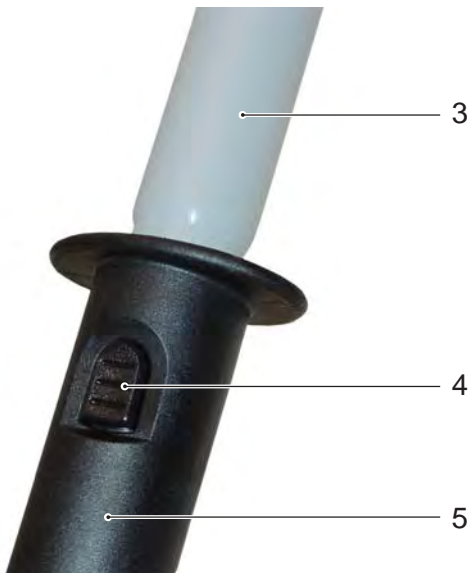

Connection, telescopic tube with holder



Cardan joint

- 1 Telescopic suction tube, middle section
- 2 Latch nose, for fixing the middle section to the lower part of the telescopic tube
- 3 Telescopic tube, lower part
- 4 Latch nose, for fixing the telescopic tube to the Cardan joint
- 5 Holder for telescopic tube
- 6 Retaining screw, Cardan joint
- 7 Spherical arresting device of the Cardan joint

Remove rechargeable battery



- 1 Rechargeable battery slot
- 2 Rechargeable battery (G1)
- 3 Unlock button, rechargeable battery

Remove rechargeable battery

The rechargeable battery must be removed from the unit as follows for recharging (2).

- Push down the unlock button (3).
- Pull the rechargeable battery (2) out of the rechargeable battery slot (1) from behind.
- Let go of the unlock button (3).
- After fully recharging the rechargeable battery (2), replace it back in the rechargeable battery slot (1).

Recharging the rechargeable battery



Standard battery charger (Standard EB 30/1)

Recharge the rechargeable battery using the standard battery charger

Recharge the rechargeable battery (7) as follows.

- Connect the rechargeable battery (7) with the plug (3).
- After fully charging the rechargeable battery (7), remove the plug (3).
- The rechargeable battery (7) can be inserted back in the unit's rechargeable battery slot (see Page 8, Item 1).



Quick battery charger (Standard EB 30/1 Professional)

Recharge the rechargeable battery using the quick battery charger

Recharge the rechargeable battery (7) as follows.

- Push the rechargeable battery (7) onto the plug (5).
- After fully charging the rechargeable battery (7), pull it off the plug (5).
- The rechargeable battery (7) can be inserted back in the unit's rechargeable battery slot (see Page 8, Item 1).



Rechargeable battery (G1)

- 1 Standard battery charger (Standard EB 30/1)
- 2 Charging mode indicator
- 3 Plug, standard battery charger
- 4 Quick battery charger (Standard EB 30/1 Professional)
- 5 Plug, quick battery charger
- 6 Charging mode and temperature monitoring indicator
- 7 Rechargeable battery (G1)
- 8 Connections, rechargeable battery

Remove brush roller



- 1 Carrier, brush roller drive unit
- 2 Unlock button, brush roller
- 3 Brush roller
- 4 Retainer, brush roller

Remove brush roller

The brush roller (3) can be removed from the unit as follows for cleaning or replacing.

- Press in the unlock button (2).
- Pull the brush roller (3) from the retainer (4).
- Pull the brush roller (3) from the carrier (1).
- Push new or cleaned brush roller (3) in the carrier (1) (ensure fits properly).
- Push the brush roller (3) into the retainer (4) until it engages.

Remove sweeping container



- 1 Release button, sweeping container
- 2 Sweeping container
- 3 Push-in slot, sweeping container

Remove sweeping container

The sweeping container (2) can be removed from the unit as follows for emptying.

- Push down the release button (1).
- Pull the sweeping container (2) out of the unit from behind.
- After emptying, push the sweeping container (2) back into the push-in slot (3) until it engages.

Lower housing removed



- 1 Outer retainer for the driving gear
- 2 Driving gear
- 3 Inner retainer of the driving gear with brush roller carrier
- 4 Drive belt
- 5 Motor pinion
- 6 Motor and electronics cover
- 7 Retaining screws (2x), motor and electronics cover
- 8 Brush roller
- 9 Retainer, brush roller

Remove motor and electronics cover

- Screw out the retaining screws (7).
- Remove the motor and electronics cover (6) from above.
- When installing the motor and electronics cover (6), ensure the motor fits properly.

Replacing the drive belt

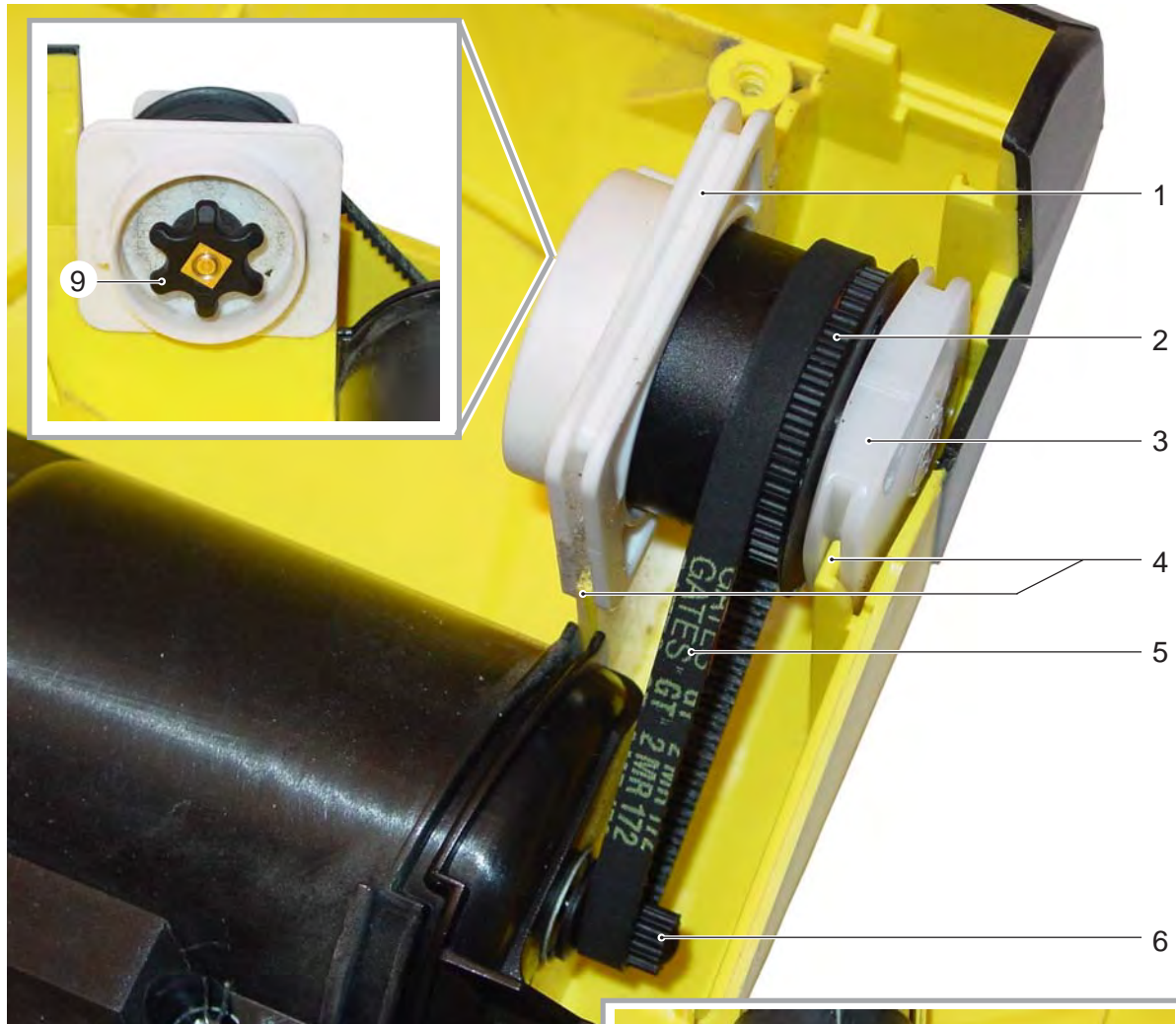

- 1 Inner retainer of the driving gear with brush roller carrier
- 2 Driving gear
- 3 Outer retainer for the driving gear
- 4 Brackets, retainer supports
- 5 Drive belt
- 6 Motor pinion
- 7 Brush roller drive unit
- 8 Motor (M1)
- 9 Brush roller carrier

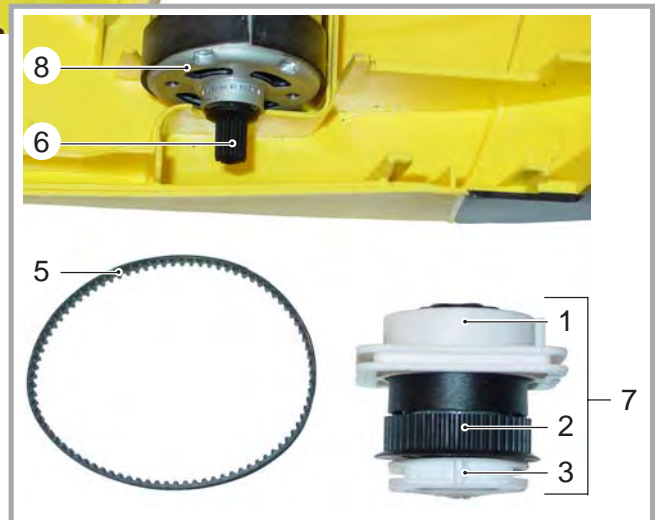

Replacing the drive belt

- Pull the brush roller drive unit (7) upwards and out of the brackets (4).
- Remove drive belt (5) from motor pinion (6) and from the brush roller drive unit (7).
- Install new drive belt in reverse order.

Motor and electronics cover removed

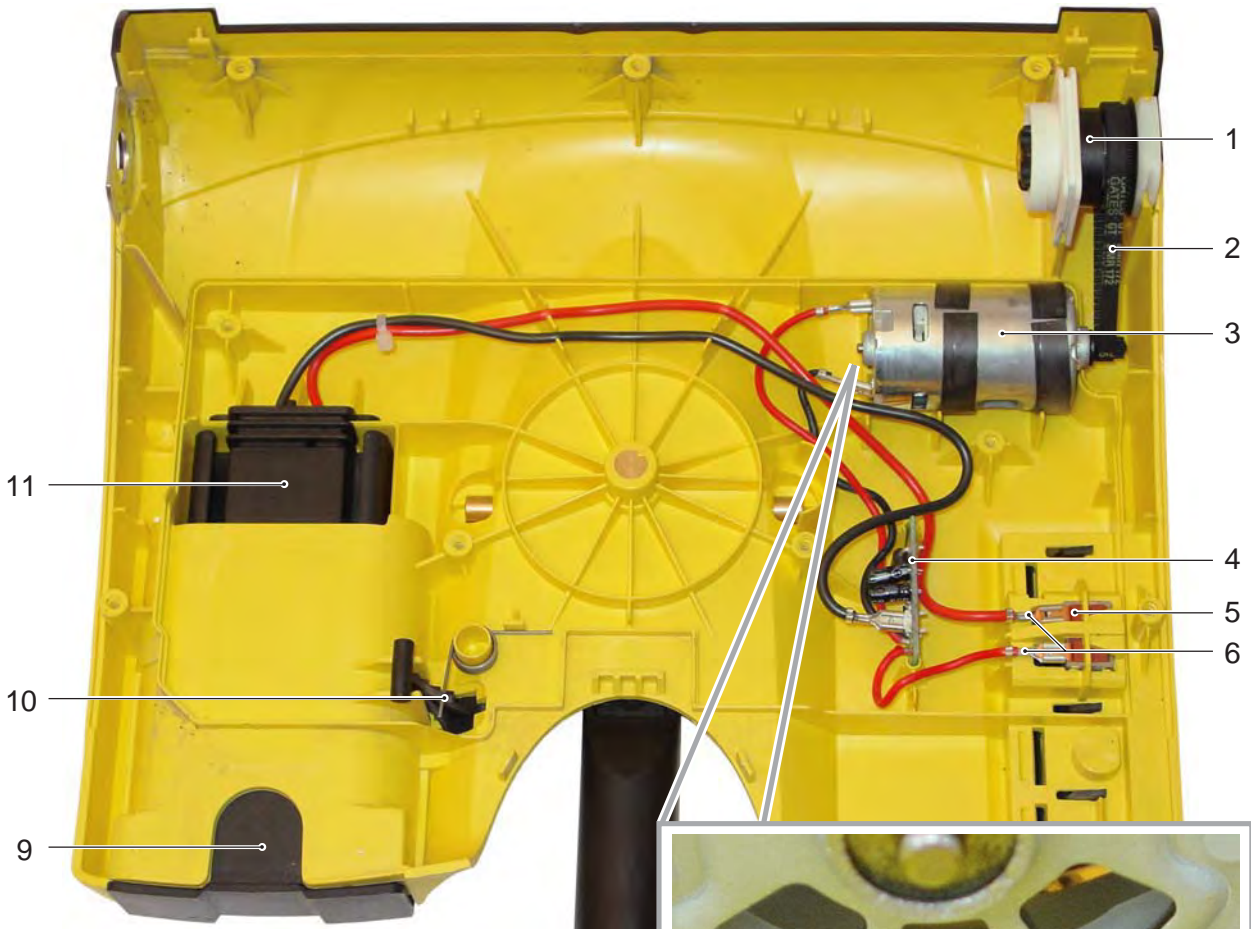

- 1 Brush roller drive unit
- 2 Drive belt
- 3 Motor (M1)
- 4 Printed circuit board (X2)
- 5 Unit switch (S1)
- 6 Connections, unit switch
- 7 Anti-twist lock
- 8 Recess for the anti-twist lock
- 9 Rechargeable battery (G1)
- 10 Unlock button, rechargeable battery
- 11 Rechargeable battery connecting plug (X1)

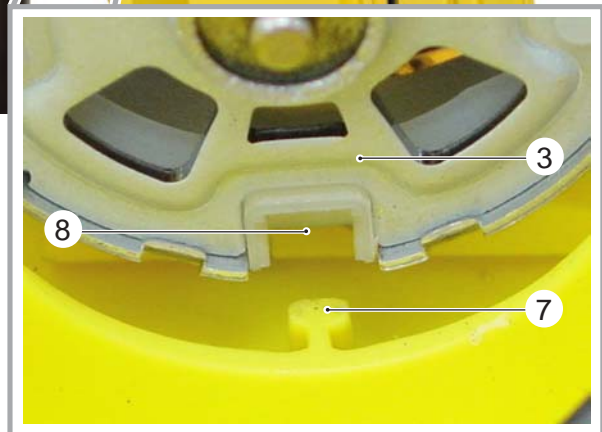
**Replacing the motor**

- Pull the motor (3) upwards and disconnect from the drive belt (2).
- Disconnect the connection cable from the motor (3).
- Install the motor in the reverse order.

Note

When inserting the motor (3) ensure that the recess (8) sits in the anti-twist lock (7).

Replacing the unit switch

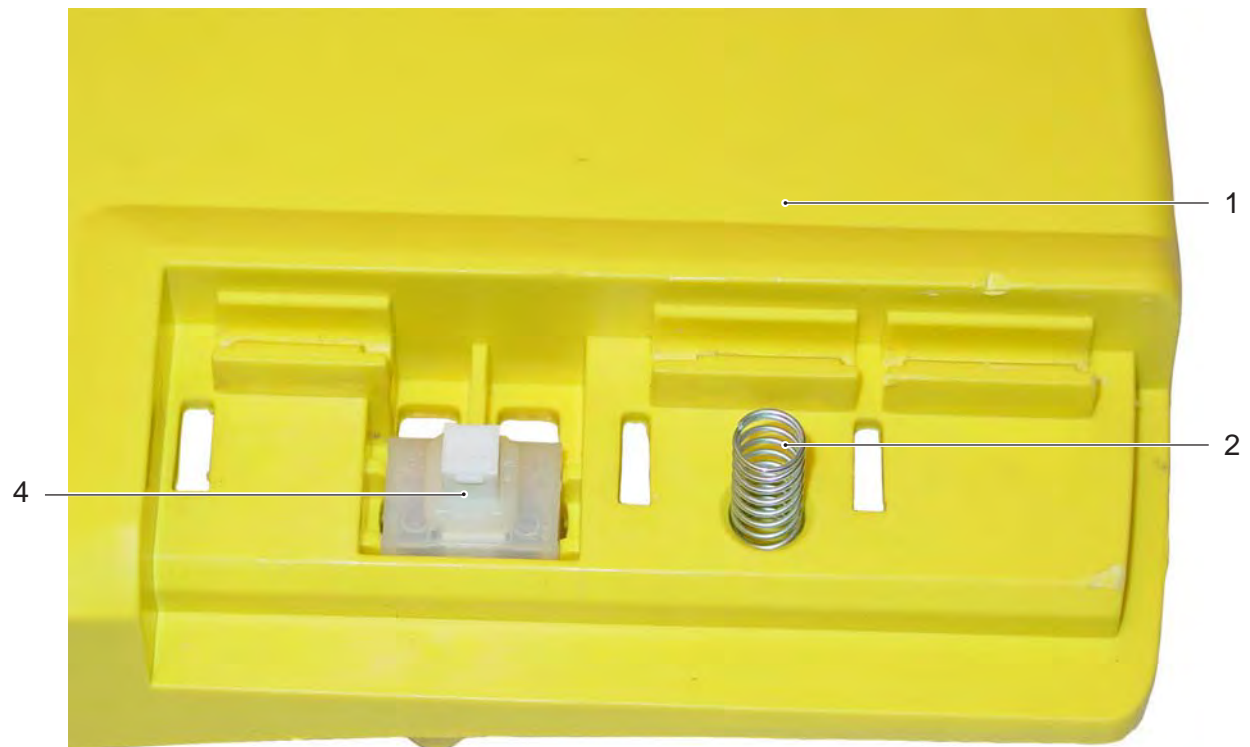

- 1 Upper part of unit
- 2 Spring
- 3 Pushbutton for unit switch (S1)
- 4 Unit switch (S1)

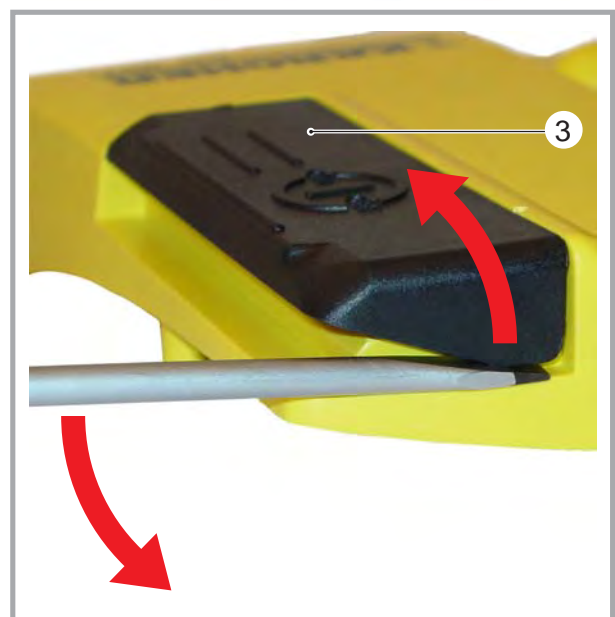

Replacing the unit switch

- Disconnect the connection cable (see Page 14, Item 6) from the unit switch (4).
- Use a screwdriver to lever the button (3) upward (see arrow in photo) and remove.
- Pull the unit switch (4) upward and out of the upper part of the unit (1).
- Insert new unit switch (4) in the upper part of the unit (1).
- Install on the button (3) by pushing it into place.
- Connect the connection cable (see Page 14, Item 6) with the unit switch (4).

Circuit diagram (0.088-835)

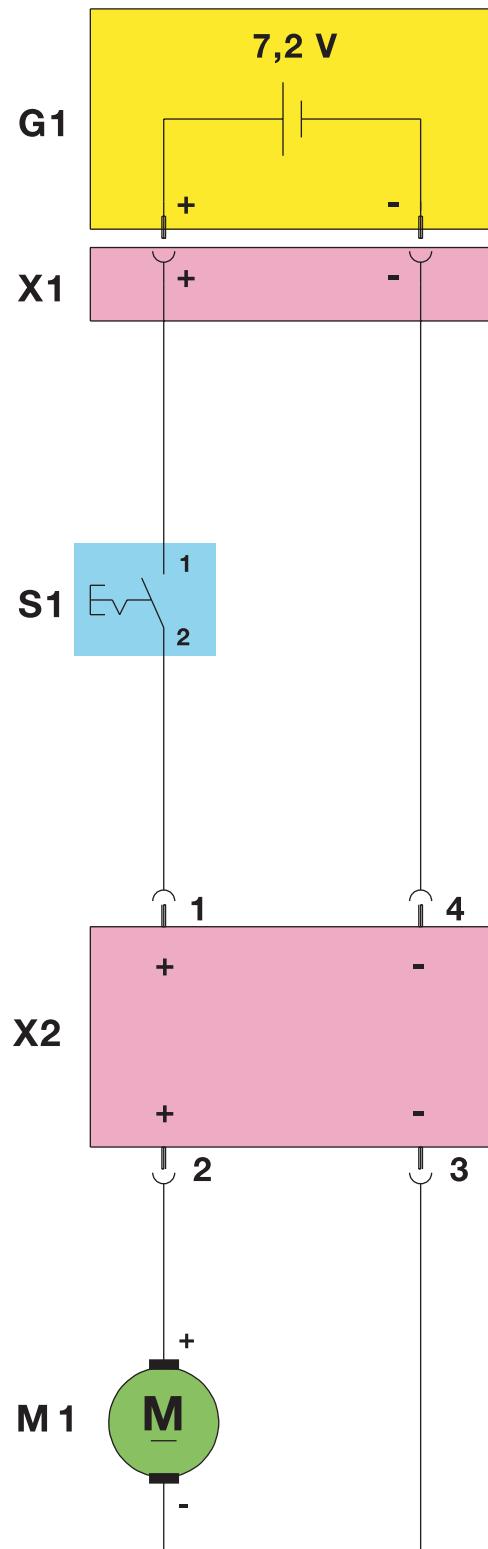
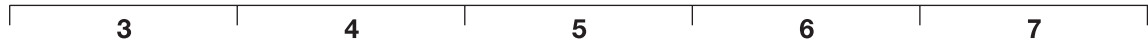

- G1 Rechargeable battery
- X1 Rechargeable battery connecting plug
- S1 Unit switch
- X2 Printed circuit board
- M1 Motor

Troubleshooting

Fault	Solution
Charging mode indicator does not light up	– Check/connect connection between battery charger and rechargeable battery. – Check/connect voltage supply from the plug.
Unit does not clean reliably	– Check brush roller for dirt - clean/replace. – Recharge rechargeable battery.
Dirt is ejected from the unit	– Empty full sweeping container.

Technical specifications

Unit type	Unit No.	Circuit diagram	Operating instructions	Spare parts list
EB 30/1 *EU	1.545-100	0.088-835	5.961-648	5.970-497
EB 30/1 *GB	1.545-102	0.088-835	5.961-648	5.970-497
EB 30/1	1.545-104	0.088-835	5.961-866	5.970-497
EB 30/1 Professional *EU	1.545-108	0.088-835	5.961-648	5.970-497
EB 30/1 Professional *GB	1.545-109	0.088-835	5.961-648	5.970-497
EB 30/1 Professional *AU	1.545-111	0.088-835	5.961-648	5.970-497
EB 30/1 Professional *EU	1.545-112	0.088-835	5.961-849	5.970-497

The technical data sheet and the circuit diagram will be included in the next issue of the spare parts CD-ROM (DISIS) and are also available in kaercher-inside (<https://kaercher-inside.com>).

If required, the operating instructions and the spare parts lists can be ordered as a paper copy from the spare parts service by quoting the relevant part number.

Special tool

No special tools are required.

Tightening torques

No details